

GAREX

JUST THE WAY YOU WANT



CARRIAGE HOUSE STYLE

VERMONT - R12 | R16



NEW HAMPSHIRE - R12 | R16



TRADITIONAL STYLE

CLASSIC - R12 | R16



SEIGNEURIE HERITAGE - R16



MODERN STYLE

QUANTUM (20 gauge white steel) - R16



WOODGRAIN - R12 | R16



PANORAMIC - NON-INSULATED

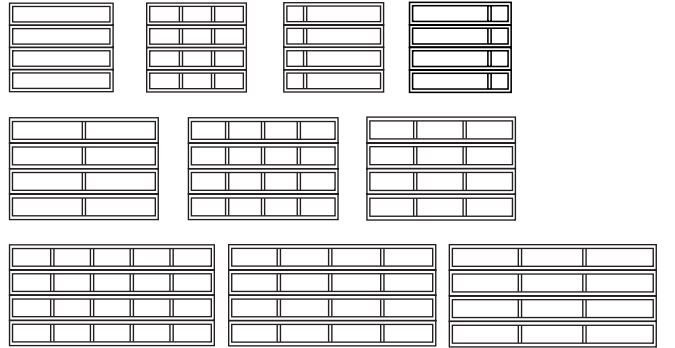

SEIGNEURIE COLLECTION - R16

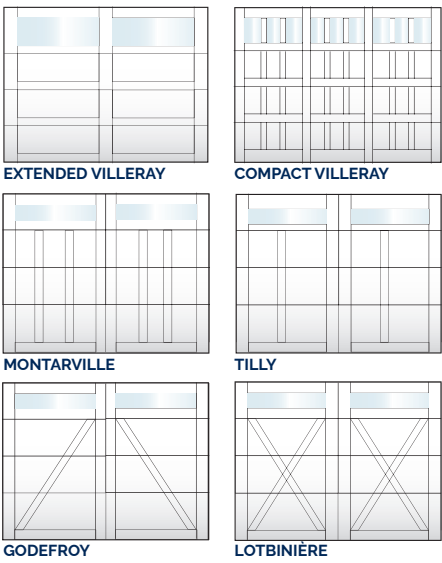
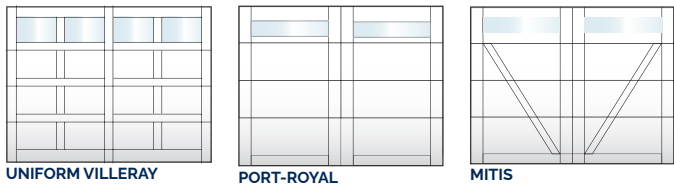

PREMIUM SERIE - R16

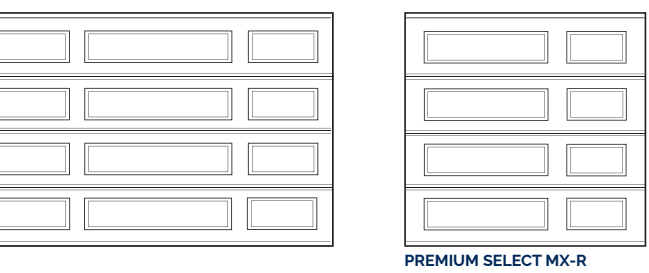
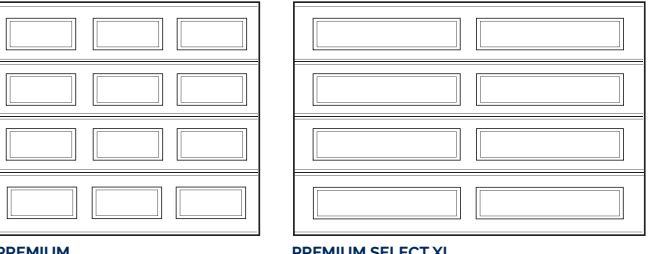
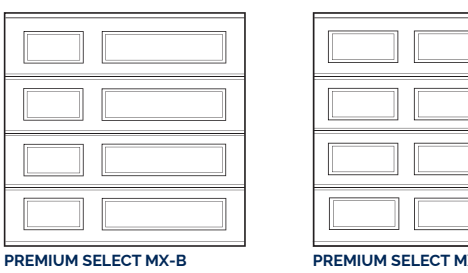

URBAN - R12 | R16



URBAN MR - R12 | R16



GROOVED - R12 | R16



MG (MULTI-GROOVE) - R16



CONTACT US
TO START YOUR
PROJECT !



DESIGNED FOR REAL LIFE

Our garage doors deliver the goods in daily life.

Smooth, trouble-free operation.

ENERGY EFFICIENCY.
DURABILITY.



Perfect for cold winters and keeping your garage warm



The best compromise between quality and price

NON-INSULATED

COMPONENTS

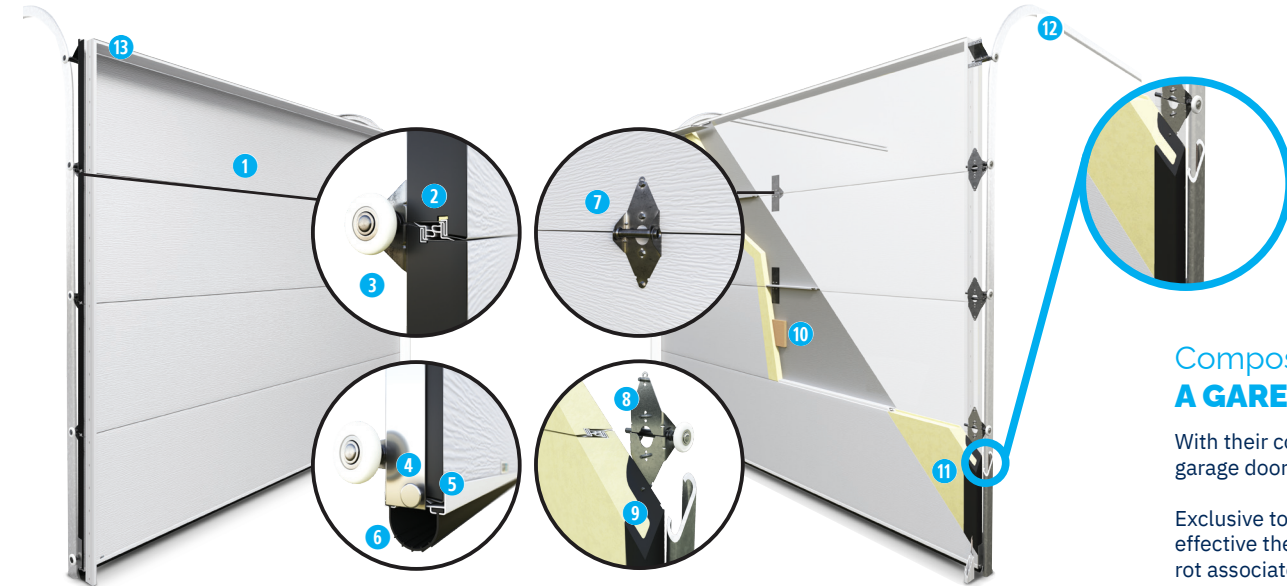

BUILT TO LAST

Composite end blocks A GAREX EXCLUSIVITY

With their composite end blocks, our insulated garage doors are the longest-lasting on the market.

Exclusive to Garex, this innovation provides an effective thermal barrier and eliminates the risk of rot associated with a wooden end.

ALWAYS AVAILABLE FAST

DELIVERY WITHIN RESPECT FOR OUR COMMITMENTS*

* For standard models and according to the delivery route.

Communicate with your installer to know the installation time

Talk to your dealer for details.

FIND A DEALER NEAR YOU:
garexdoors.com/en/find-a-dealer



SATISFACTION MADE EASY

IMPECCABLE INSTALLATION

Treat yourself to peace of mind!

Our highly trained installers and easy-to-install garage doors deliver instant satisfaction that sticks around!



GAREX



RESIDENTIAL GARAGE DOORS

WELL DESIGNED
EASY TO CUSTOMIZE
QUICK TO INSTALL

PERFORMANCE MADE SIMPLE



- 1 PANEL**
26 gauge (0,035") galvanized steel panel or 23 gauge (0,024") treated aluminium panel

COATING DESCRIPTION



For aluminum coating, chromate pre-treatment is used instead of galvanization

- 2 WEATHER SEALS AND JOINT SEAL**



No air circulation between the panels, providing perfect sealing.

- 3 ROLLERS**
White nylon rollers with ball bearings.

- 4 BOTTOM BRACKETS**
14 gauge (0,075") galvanized steel.

- 5 BOTTOM RETAINER**
Ultra-resistant white PVC for weatherstripping insertion.

- 6 WEATHER SEALS**
"U" Flexible rubber inserted into a PVC reinforced Moulding offering a tightly sealed fit to the floor.

- 7 HALF-HINGE AT THE CENTER**
14 gauge.

- 8 FULL-HINGES AT THE ENDS**
14 gauge.

- 9 COMPOSITE END-BLOCK**
Extruded composite XPS end block: an exclusivity of GAREX.

- 10 WOOD PLATE**
Optional for centre lock reinforcement.

- 11 POLYURETHANE (R-12 AND R-16)**
Polyurethane foam insulation pressure-injected.

- 12 TRACKS**
12" standard radius, 14 gauge (0,075") galvanized steel. Reinforcement on horizontal rails for doors of 13' and over.

- 13 WEATHER SEALS**
High-performance weatherstripping ensuring increased weathertightness and stays flexible through the coldest temperatures.



GARAGE DOORS
1 3/8" STEEL OR ALUMINUM
R-12 INSULATION



GARAGES DOORS
1 1/4" STEEL OR ALUMINUM
R-16 INSULATION

